



Irrigation Pre-Construction – Load Checklist

Office Received Date: _____ Service Order #: _____
(ACEC Office Use Only)

Member Information

Applicant Name:

Second Applicant Name:

Current Mailing Address:

City:

State:

Zip:

Providing an email address allows ACEC to send courtesy notifications about the status of your electric service installation

Email:

Would you like to receive your paperwork via email? ☐ Yes ☐ No

Business Phone:

Cell Phone:

Irrigation Contractor Information

Company Name:

Contact Person:

Address:

City:

State:

Zip:

Email:

Business Phone:

Cell Phone:

Electrician Information (If different than irrigation contractor)

Company Name:

Contact Person:

Address:

City:

State:

Zip:

Email:

Business Phone:

Cell Phone:

Site Information

Street/Intersection:

City/Town/Village:

County:

Tax Parcel ID #:

Do you own the property? ☐ Yes ☐ No

Current Construction Stage: ☐ No Start ☐ Field Cleared ☐ Service & Well Marked ☐ Main Disconnect Installed

(Continued on back)

Responsible Party Information (Please select one for each statement)			
	Member	Irrigation Contractor	Electrician
Who is the main contact/responsible party during construction?	<input type="checkbox"/>	<input type="checkbox"/>	<input type="checkbox"/>
Who is responsible for charges?	<input type="checkbox"/>	<input type="checkbox"/>	<input type="checkbox"/>
Who is responsible for electric installation?	<input type="checkbox"/>	<input type="checkbox"/>	<input type="checkbox"/>
Electric Service Requirements			
Service: <input type="checkbox"/> Single Phase 240/480 (All single phase must be ACEC Engineer approved) <input type="checkbox"/> Three Phase 277/480			
Well Pump Size: _____	Field Name: _____	Gallons Per Minute: _____	
Trace Wire: <input type="checkbox"/> Yes <input type="checkbox"/> No	GPS Control: <input type="checkbox"/> Yes <input type="checkbox"/> No	Est. date electric service will be needed: _____	
Load Information (Indicate if equipment will be at the service location)			
<input type="checkbox"/> VFD <input type="checkbox"/> Booster Pump <input type="checkbox"/> HP Motor for Pivot <input type="checkbox"/> Other: _____			
Additional Comments			

Estimates provided are only valid for the current construction season. If job is done during our non-construction season (November – April), additional charges may apply.

BEFORE ENGINEERING CAN BEGIN

1. Application for Service

The application for service must be completed in entirety and is required to meet membership obligations.

2. Load Checklist

ACEC requests some basic information about the electric load you plan to have at your site. This helps us properly size facilities to meet your demands. Your electrician may be able to help you complete the service requirements portion.

3. Site Plan

This is a drawing or sketch of your property. To properly design your new electric service and choose the best path for buried electric cable, ACEC must know ahead of time where you wish to place your meter. Identify as many things as possible. It is important for us to know the location of all existing and future facilities, structures, and other potential obstructions. Clearly mark a meter point at your site for ACEC to measure from. Consult with your electrician or building contractor regarding potential meter locations. If you need assistance in choosing a meter location, an ACEC Distribution Design Technician (DDT) can meet with you on-site to discuss location options.

4. All three forms must be received at our office before a site visit will be done.

BEFORE CONSTRUCTION CAN BEGIN

- All forms and fees must be received at our office.
- The service route must be cleared – 10 foot wide path cleared of all brush, etc.
- The meter pedestal must be installed and inspected per ACEC's [Service Requirements](#).
- Any underground facilities must be marked and/or exposed (i.e. trace wire, drain tile).
- All forms, fees, and inspection must be received at our office.

Irrigation Site Plan

Member Information		
Member Name:		Property Address:
City:	State:	Zip:
Additional Comments		

See sample site plan sketch below. Complete your sketch on the reverse side. Reminder – a clear 10' path is required to install and maintain your electric service.

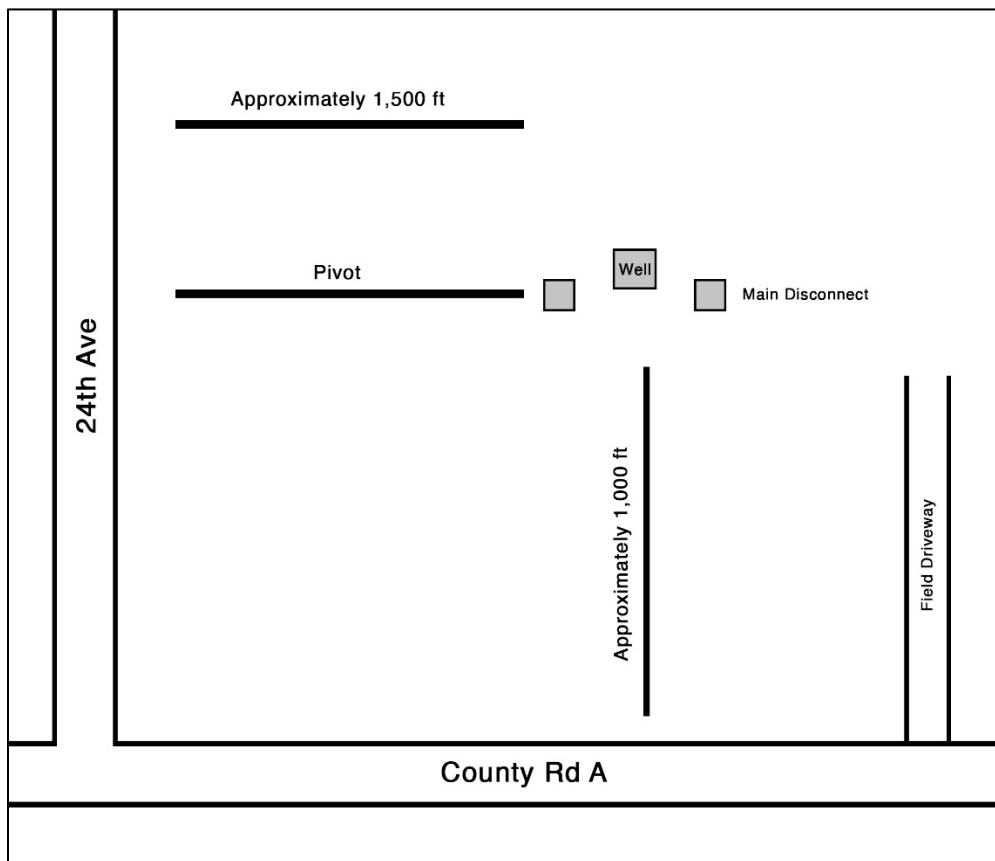

Items that should be identified:

- Tracer
- Wire
- Well
- Main Disconnect
- Field Access
- Roads