

# 2024 ACEC Irrigation Meeting



**Speaker:**

**Mark LaMore – Engineering/Operations Support Specialist-Key Accounts**

## *Topics of Discussion*

- Finished & Upcoming Projects
- Demarcation Point
- Construction Costs
- SmartHub
- Peak Alert
- Cost of Service Study
- 2024 Rates
- Navigating Your Bill
- Question & Answer





# Irrigation Projects

---

- Every year ACEC replaces 10 – 12 irrigation lines
  - This is old wire whether long runs of secondary or P175
- Meter socket incentive.
- Transfer ownership to member.

# Demarcation Point of ACEC's Facilities

- Wisconsin Electrical Statute changed stating a master electrician must install the secondary wire between the meter socket and disconnect.
- Meter must be within 25 feet of the disconnect. Variance with Engineering VD calculation.
- Allowing meter socket to be built onto the backboard
- Member owns/maintains meter socket.

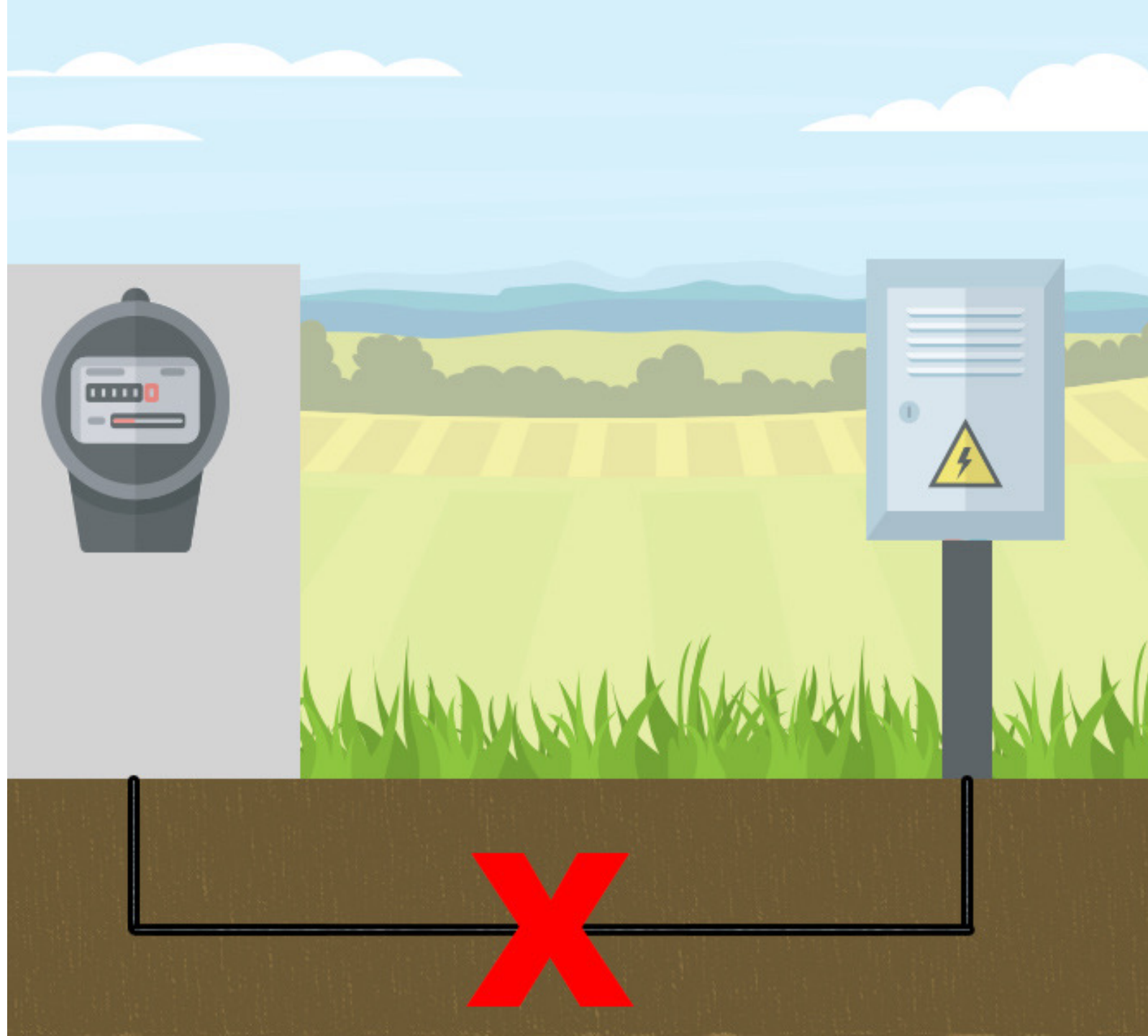



# Construction Costs

- New construction and remove/relocates are based on time and material

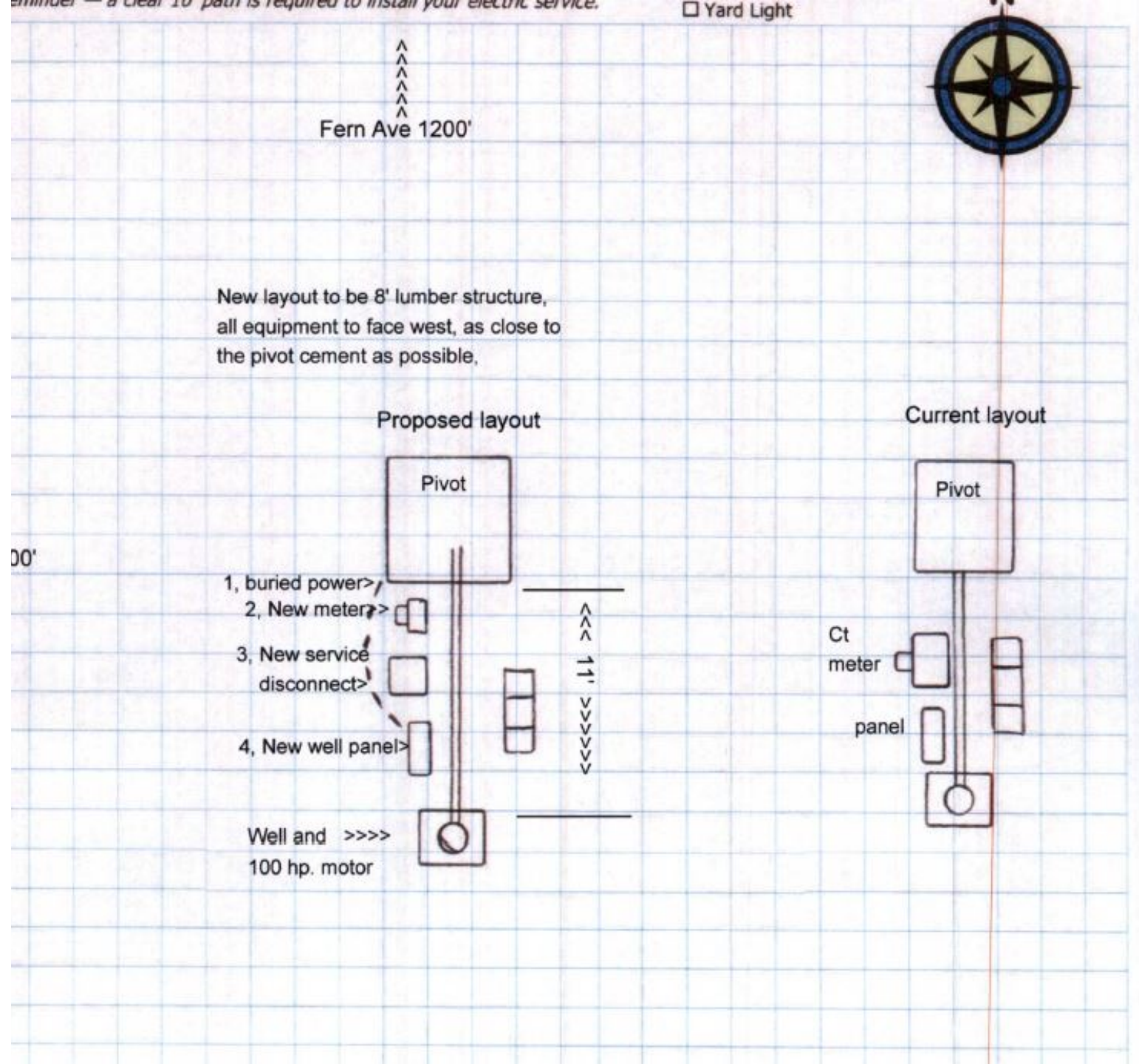

# SmartHub Tutorial



## Home Screen Overview

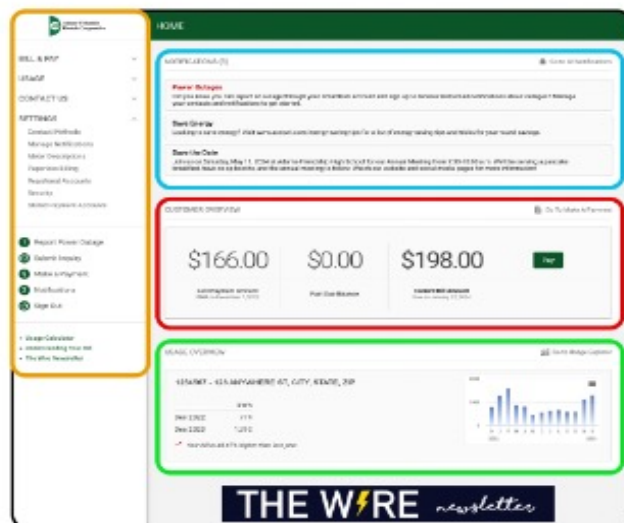

### Navigation Pane

The navigation pane is your main menu and will direct you to any page within SmartHub. To return back to the home screen, click our logo.

### Notifications

These alerts are information ACEC wants you to know about. Click "Go To All Notifications" to view all messages we've sent directly to you.

### Customer Overview

At a glance you can view your last payment amount, past due balance, and current bill amount for all of your accounts. Click the "Pay" button to see the details for each account.

### Usage Overview

Review a snapshot of your energy usage from the last year and compared to last year at this time. For a deeper dive into your energy usage, click the "Usage" drop down from the navigation pane.

## Download the mobile app!

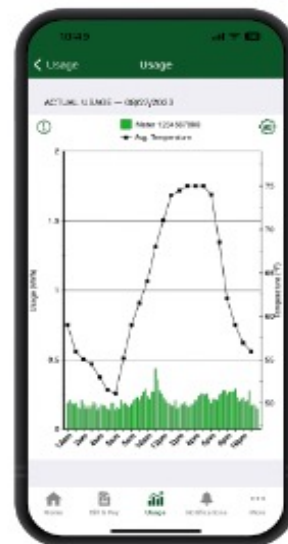

**Adams-Columbia  
Electric Cooperative**



(800) 831-8629



acec@acecwi.com



www.acecwi.com



401 E Lake St, Friendship, WI

## SmartHub

Online portal for members  
to manage their account

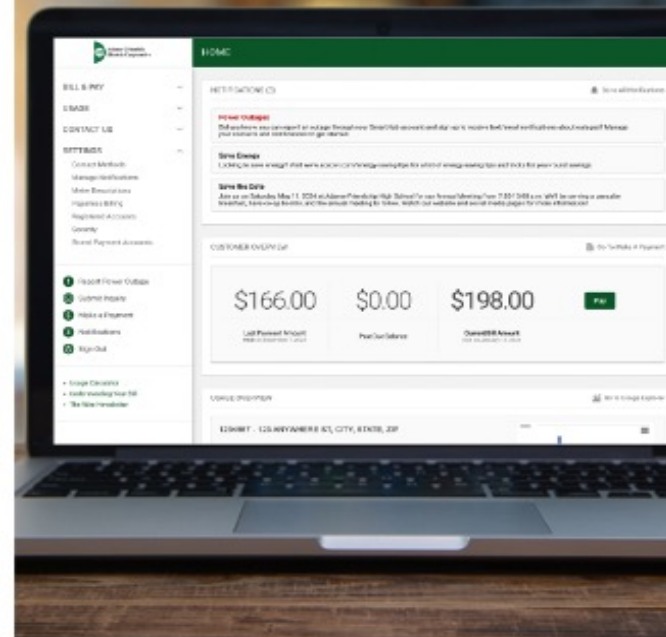

Log in or create an account by  
visiting our website.

[acecwi.smarthub.coop](http://acecwi.smarthub.coop)



## BILL & PAY

Auto Pay Program  
Billing History  
Make a Payment  
Operation Round Up  
Payment History

### Auto Pay

Auto pay automatically deducts your monthly bill from your bank account or card on your due date.



### Billing History & Payment History

The billing history and payment history tabs allow you to view past bill statements and payments applied to your account.

### Make a Payment

You can make a payment on your account, view the due dates, and schedule future payments.

### Operation Round Up

This program is funded by members who choose to round their bill up to the nearest dollar amount. The extra change is used to support organizations and individuals who apply for our grant throughout our service area.



You can enroll your account in Operation Round Up to make a impact on local communities.

## USAGE

Average Usage  
Usage Comparison  
Usage Explorer  
Usage Tracking

### Usage Features

Explore the usage graph options by viewing your average energy usage for the month, day of the week, or time of day.

The comparison tool allows you to view two different months side by side. Usage explorer shows your usage in a variety of ways.

Take control by tracking your usage to see spikes or dips in energy consumption.

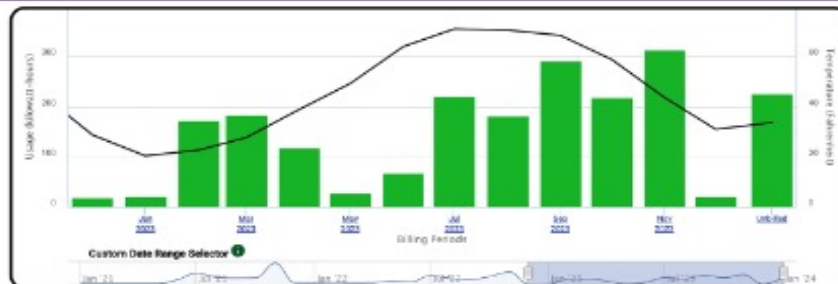

## CONTACT US

Location  
Report Power Outage  
Submit Inquiry  
Track Issue Status

### Location

Get directions to our Friendship office with a map built in to SmartHub.



### Report Power Outage

Report your outage through your SmartHub account to link the outage directly to your service location.



### Submit Inquiry

Submit updates or questions about your account.

One of our customer service representatives will be in contact with you after we receive your request.

### Track Issue Status

Details about current power outages in your area and power outage history for your service locations are available here.

## SETTINGS

Contact Methods  
Manage Notifications  
Meter Descriptions  
Paperless Billing  
Registered Accounts  
Security  
Stored Payment Accounts

### Contact Methods

Add your phone number and email to your account so you can receive notifications.



### Manage Notifications

After adding your contact methods, check out the variety of text and email notifications you can receive.

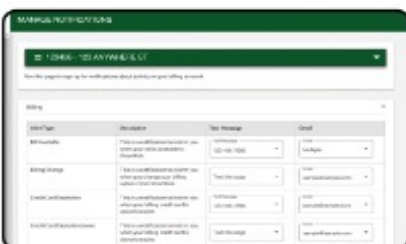

### Meter Description

Rename your meter (house, garage, shed, etc.)

### Paperless Billing

Sign up to receive emailed monthly statements.

### Registered Accounts

Shows your account and additional users.

### Security

Change your password, email, or security phrase.

### Stored Payment Accounts

Information will be stored for future payments.





PEAK ALERT





# Determining Peak Alert

- Predictions come from Alliant Energy, whose territory Iowa & Wisconsin
- Daily predictions received around 9:30 a.m.
- These numbers change constantly
- Dispatch monitors constantly and uses weather data, past peaks, and peak alert periods
- High or Low Peak Alert Messages
- ACEC Web Site Load Management History
- Use SmartHub to update notification list.

## LOAD MANAGEMENT HISTORY

HISTORICAL DATA REGARDING HIGH PEAK PERIODS

### 2023

May 8: 10 a.m. – 3 p.m.

May 9: 10 a.m. – 3 p.m.

May 10: 1 – 6 p.m.

May 11: 1 – 6 p.m.

May 22: 2 – 7 p.m.

May 23: 1 – 7 p.m.

May 30: 2 – 8 p.m.

May 31: 2 – 8 p.m.

**Peak for the month: May 31 @ 5 p.m. (hour ending)**

June 1: 1 – 7 p.m.

June 2: 1 – 7 p.m.

June 5: 4 – 7 p.m.

June 19: 3 – 5 p.m.

June 20: 3 – 5 p.m.

June 21: 2 – 6 p.m.

June 22: 2 – 5 p.m.

June 23: 2 – 6 p.m.

June 29: 3 – 7 p.m.

June 30: 3 – 7 p.m.

**Peak for the month: June 29 @ 6 p.m. (hour ending)**

---

# Cost of Service Study

- ACEC contracts Power Systems Engineering to evaluate the Cost of Service for members and adjust as our industry changes.





# Let's Talk Rates

We evaluate rates by looking at our current rate structure and projections of wholesale power costs to ensure our rates are set fairly for each rate class and are adequate to cover our expenses at the cooperative. Increases across the industry, including cost of material and purchased power, factor into our rates.

Due to continuous changes in the energy market and additional infrastructure, primarily from solar projects, our power supplier, Alliant Energy, has increased our wholesale power rates. Our demand billed members will see this increase in their demand rates, and our residential members will see this increase in the power cost adjustment. Our 4.5% ownership in Alliant's West Riverside Energy Center in Beloit, WI (natural gas-fired power plant) has helped offset rate costs.

# RATES

## ElectricRate.com The electricity value chain



Generation



Transmission



Distribution



Households

# 2024 Irrigation Rates – Coincident Peak

- Facility Charge
  - \$1,080 annually
    - Rate Code: MC6,NC6 – 12-month billing
      - \$90/month
- Energy Charge
  - On-Peak: 3.9¢/KWH
    - All hours including weekends and holidays.
- Demand Charge
  - Distribution Demand
    - \$7.50/kw of maximum demand
    - Any month demand is incurred
  - Coincident Peak Demand
    - \$38.58/kw of demand measured at the time of ACEC's power supply coincident peak
    - 12 months including weekends and holidays. (Change from 6 months).



# 2023 to 2024 CP Comparison With CP

100hp 1100GPM Well

- 2023

- **Facility Charge**

- -\$85.00 \$85.00

- **Irrigation-Farm Service**

- -.039 x 27,247 KWH \$1,062.63

- **Peak Demand Charge**

- -\$33.60 x 65.354 KW \$2,195.89

- **Demand Charge**

- -\$6.50 x 69.797 \$453.68

- **Power Cost Adj**

- - \$-.0173 X 27,247 KWH \$471.37 CR

- WI Non-Tax program @ 3% \$1.50

- Total Amount Due \$3,327.33

- 2024

- **Facility Charge**

- -\$90.00 \$90.00

- **Irrigation-Farm Service**

- -.039 x 27,247 KWH \$1,062.63

- **Peak Demand Charge**

- -\$38.58 x 65.354 KW \$2,521.36

- **Demand Charge**

- -\$7.50 x 69.797 \$523.48

- **Power Cost Adj**

- - \$-.0173 X 27,247 KWH \$471.37 CR

- WI Non-Tax program @ 3% \$1.50

- Total Amount Due \$3,727.60

# Coincident Peak

Service Address: WELL EFG			Service Desc:			Map Location: 1222-33-444			
Meter Reading Details		From: 06/01/2023		To: 07/01/2023		Detail of Charges			\$ Amount
		Number of Days: 30							
Meter	Rate	Previous	Current	Mult	Usage				
kWh	148155652 MC6A	51434	78682	1	27247	Balance Forward			\$0.00
kW	148155652 MC6A		65.354	1	65.354	Facility Charge			\$90.00
kW	148155652 MC6B		69.797	1	69.797	Irrigation-Farm Service			
						27,247 kWh @ 0.039			\$1,062.63
						Peak Demand Charge			
						65.354 kW @ 38.58			\$2,521.36
						Demand Charge			
						69.797 kW @ 7.50			\$523.48
						Power Cost Adjustment			
						27,247 kWh @ -0.0173			\$471.37 CR
						WI Non-Taxable Program @ 3.00%			\$1.50
						Current Electric Charges			\$3,727.60
						Total Electric Charges			\$3,727.60
						Total Amount Due			\$3,727.60
Total Usage						27247			
Total Demand						135.15			
Please see reverse side for usage history graph.									
Information									
Help us stuff the bus this month! We're accepting donations of new, unused school supplies to donate to local back-to-school programs throughout our service area. Donations may be dropped off at our Friendship office until Friday, July 28th.									
Coincident Peak: June 29 - Hour Ending 6:00 p.m.									

# Coincident Peak

Service Address: WELL EFG			Service Desc:			Map Location: 1222-33-444			
Meter Reading Details		From: 06/01/2023		To: 07/01/2023		Detail of Charges		\$ Amount	
		Number of Days:		30					
Meter		Rate	Previous	Current	Mult	Usage			
kWh	148155652	MC6A	51434	78682	1	27247	Balance Forward		\$0.00
kW	148155652	MC6A		0	1	0	Facility Charge		\$90.00
kW	148155652	MC6B		69.797	1	69.797	Irrigation-Farm Service		
							27,247 kWh @ 0.039		\$1,062.63
							Demand Charge		
							69.797 kW @ 7.50		\$523.48
							Power Cost Adjustment		
							27,247 kWh @ -0.0173		\$471.37 CR
							WI Non-Taxable Program @ 3.00%		\$1.50
Total Usage							27247		
Total Demand							69.797		
Please see reverse side for usage history graph.									
Information									
Help us stuff the bus this month! We're accepting donations of new, unused school supplies to donate to local back-to-school programs throughout our service area. Donations may be dropped off at our Friendship office until Friday, July 28th.									
Coincident Peak: June 29 - Hour Ending 6:00 p.m.									
							Total Electric Charges		\$1,206.24
							Total Electric Charges		\$1,206.24
							Total Amount Due		\$1,206.24



# 2024 Irrigation Rates – Time of Use

- Facility Charge
  - \$1,080 annually
    - Rate Code: T6 – 12-month billing
      - \$90/month
- Energy Charge
  - On-Peak: 3.9¢/KWH
    - All hours including weekends and holidays.
- Demand Charge
  - Distribution Demand
    - \$7.50/kw of maximum demand
    - Any month demand is incurred
  - Peak Demand
    - \$ 24.50 per kW of registered maximum demand, between the hours of 1:00 p.m. - 7:00 p.m. Monday through Friday.

# 2023 to 2024 TOU Comparison

40hp 600GPM Well

- 2023

- **Facility Charge**

- -\$85.00 \$85.00

- **Irrigation-Farm Service**

- -.039 x 1226 KWH-Peak \$47.81

- -.039 x 5032 KWH- Off Peak \$196.25

- **Peak Demand Charge**

- -\$24.50 x 42.948 KW \$1,052.23

- **Demand Charge**

- -\$6.50 x 45.151 \$293.48

- **Power Cost Adj**

- - \$.002221 X 1226 KWH \$2.72

- - \$.002221 X 5032 KWH \$11.18

- WI Non-Tax program @ 3% \$1.50

- Total Amount Due \$1,690.17

- 2024

- **Facility Charge**

- -\$90.00 \$90.00

- **Irrigation-Farm Service**

- -.039 x 1226 KWH-Peak \$47.81

- -.039 x 5032 KWH- Off Peak \$196.25

- **Peak Demand Charge**

- -\$24.50 x 42.948 KW \$1,052.23

- **Demand Charge**

- -\$7.50 x 45.151 \$338.63

- **Power Cost Adj**

- - \$.002221 X 1226 KWH \$2.72

- - \$.002221 X 5032 KWH \$11.18

- WI Non-Tax program @ 3% \$1.50

- Total Amount Due \$1,740.32

# Time of Use

Service Address: WELL ABC			Service Desc:				Map Location: 1234-56-789	
Meter Reading Details		From: 07/01/2023		To: 08/01/2023		Detail of Charges		\$ Amount
		Number of Days:		31		Balance Forward		\$0.00
	Meter	Rate	Previous	Current	Mult	Usage		
On Peak kWh	152672671	T6-A	43923	50181	1	1226	Facility Charge	\$90.00
On Peak kW	152672671	T6-A		42.948	1	42.948	Irrigation-Farm Service - Peak 1,226 kWh @ 0.039	\$47.81
Mid Peak kWh	152672671	T6-B	43923	50181	1	5032	Irrigation-Farm Service - Off Peak 5,032 kWh @ 0.039	\$196.25
Mid Peak kW	152672671	T6-B		45.151	1	45.151	Peak Demand Charge 42.948 kW @ 24.50	\$1,052.23
Total Usage						6258	Demand Charge 45.151 kW @ 7.50	\$338.63
Total Demand						88.1	Power Cost Adjustment 1,226 kWh @ 0.002221	\$2.72
Please see reverse side for usage history graph.								
Information								
Coincident Peak: July 27 - Hour Ending 5:00 p.m.								
Mark your calendars for our upcoming Tailgate Events this fall!								
September 22nd at Adams-Friendship Middle School and October 6th								
at Wautoma High School. Read this issue of The Wire to learn more.								
							Power Cost Adjustment 5,032 kWh @ 0.002221	\$11.18
							WI Non-Taxable Program @ 3.00%	\$1.50
							Current Electric Charges	\$1,740.32
							Total Electric Charges	\$1,740.32
							Total Amount Due	\$1,740.32



# Time of Use

Service Address: WELL ABC			Service Desc:				Map Location: 1234-56-789	
Meter Reading Details		From: 07/01/2023		To: 08/01/2023		Detail of Charges		\$ Amount
		Number of Days:		31				
	Meter	Rate	Previous	Current	Mult	Usage		
On Peak kWh	152672671	T6-A	43923	50181	1	1226	Balance Forward	\$0.00
On Peak kW	152672671	T6-A		0	1	0	Facility Charge	\$90.00
Mid Peak kWh	152672671	T6-B	43923	50181	1	5032	Irrigation-Farm Service - Peak	
Mid Peak kW	152672671	T6-B		45.151	1	45.151	1,226 kWh @ 0.039	\$47.81
							Irrigation-Farm Service - Off Peak	
							5,032 kWh @ 0.039	\$196.25
							Demand Charge	
							45.151 kW @ 7.50	\$338.63
							Power Cost Adjustment	
							1,226 kWh @ 0.002221	\$2.72
							Power Cost Adjustment	
							5,032 kWh @ 0.002221	\$11.18
							WI Non-Taxable Program @ 3.00%	\$1.50
							Current Electric Charges	\$688.09
							Total Electric Charges	\$688.09
							Total Amount Due	\$688.09

Please see reverse side for usage history graph.

**Information**

Coincident Peak: July 27 - Hour Ending 5:00 p.m.

Mark your calendars for our upcoming Tailgate Events this fall!

September 22nd at Adams-Friendship Middle School and October 6th at Wautoma High School. Read this issue of The Wire to learn more.

# Question & Answer



**Mark LaMore – Engineering/Operations Support Specialist-Key Accounts**

**mlamore@acecwi.com**

**(800) 831-8629**

**(608) 547-1076**